



## 10 Waveguide Termination (Dummy Load)

### 10.1 Waveguide Low Power Termination



HengDa Microwave's standard product line of low power terminations utilizes precision conical load elements for optimum electrical performance. This series of terminations is designed for low power input. VSWR is less than 1.05 over the full waveguide bandwidth.

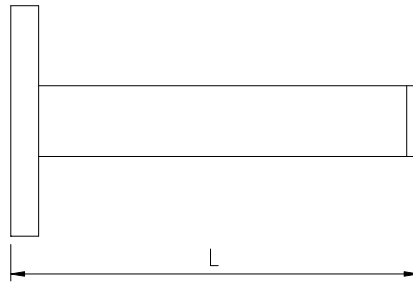

#### 【Specifications】

Model No*	Freq Range (GHz)	VSWR (Max)	Avg Power (W)	Length (L) (mm)	WG Type		Flange	Material
					IEC	EIA		
HD-3WL1.05...	0.32-0.49	1.05	2	2005	R3	WR2300	FDP/FDM	Al
HD-4WL1.05...	0.35-0.53	1.05	2	1900	R4	WR2100	FDP/FDM	Al
HD-5WL1.05...	0.41-0.62	1.05	2	1600	R5	WR1800	FDP/FDM	Al
HD-6WL1.05...	0.49-0.75	1.05	2	1300	R6	WR1500	FDP/FDM	Al
HD-8WL1.05...	0.64-0.98	1.05	2	1100	R8	WR1150	FDP/FDM	Al
HD-9WL1.03...	0.75-1.15	1.03	2	660	R9	WR975	FDP/FDM	Al
HD-12WL1.05...	0.96-1.46	1.05	2	680	R12	WR770	FDP/FDM	Al
HD-14WL1.03...	1.13-1.73	1.03	2	570	R14	WR650	FDP/FDM	Al
HD-18WL1.05...	1.45-2.20	1.05	2	550	R18	WR510	FDP/FDM	Al/Cu
HD-22WL1.03...	1.72-2.61	1.03	2	470	R22	WR430	FDP/FDM	Al/Cu
HD-26WL1.03...	2.17-3.30	1.03	2	350	R26	WR340	FDP/FDM	Al/Cu
HD-32WL1.03...	2.60-3.95	1.03	2	278	R32	WR284	FDP/FDM	Al/Cu
HD-40WL1.03...	3.22-4.90	1.03	2	275	R40	WR229	FDP/FDM	Al/Cu
HD-48WL1.03...	3.94-5.99	1.03	2	170	R48	WR187	FDP/FDM	Al/Cu
HD-58WL1.03...	4.64-7.05	1.03	2	135	R58	WR159	FDP/FDM	Al/Cu
HD-70WL1.03...	5.38-8.17	1.03	2	180	R70	WR137	FDP/FDM	Al/Cu



HD-84WL1.03...	6.57-9.99	1.03	2	150	R84	WR112	FBP/FBM/FBE	Al/Cu
HD-100WL1.03...	8.20-12.40	1.03	2	130	R100	WR90	FBP/FBM/FBE	Al/Cu
HD-120WL1.03...	9.84-15.0	1.03	2	110	R120	WR75	FBP/FBM/FBE	Al/Cu
HD-140WL1.03...	11.9-18.0	1.03	2	90	R140	WR62	FBP/FBM/FBE	Al/Cu
HD-180WL1.03...	14.5-22.0	1.03	2	75	R180	WR51	FBP/FBM/FBE	Al/Cu
HD-220WL1.03...	17.6-26.7	1.03	2	85	R220	WR42	FBP/FBM/FBE	Al/Cu
HD-260WL1.03...	21.7-33.0	1.03	2	55	R260	WR34	FBP/FBM/FBE	Al/Cu
HD-320WL1.03...	26.3-40.0	1.03	2	40	R320	WR28	FBP/FBM/FBE	Al/Cu

\*Indicates Model Number. See Ordering Information for complete part number.

**【Ordering Information】**

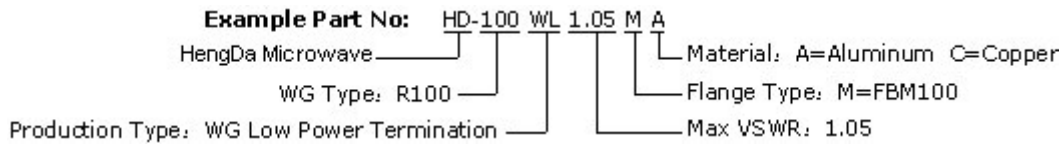

- Flange type: Multiple types available - see HengDa Microwave Flanges page
- Finish: Corrosion protection plus black top coat

**10.2 Waveguide High Power Termination**



HengDa Microwave manufactures a wide selection of high power terminations. Please call us and discuss your special needs with one of our sales engineers.

**【Specification】**

Model No*	Freq Range (GHz)	VSWR** (Max)	Avg Power (W)	WG Type		Flange	Material
				IEC	EIA		
HD-14WHPL100...	1.13-1.73	1.20	100	R14	WR650	FDP/FDM	Al
HD-14WHPL350...	1.13-1.73	1.20	350	R14	WR650	FDP/FDM	Al
HD-14WHPL500...	1.13-1.73	1.20	500	R14	WR650	FDP/FDM	Al
HD-14WHPL1000...	1.13-1.73	1.20	1000	R14	WR650	FDP/FDM	Al



## Xi'an HengDa Microwave Technology Development Company

HD-18WHPL100...	1.45-2.20	1.20	100	R18	WR510	FDP/FDM	Al/Cu
HD-18WHPL300...	1.45-2.20	1.20	300	R18	WR510	FDP/FDM	Al/Cu
HD-18WHPL500...	1.45-2.20	1.20	500	R18	WR510	FDP/FDM	Al/Cu
HD-18WHPL1000...	1.45-2.20	1.20	1000	R18	WR510	FDP/FDM	Al/Cu
HD-22WHPL100...	1.72-2.61	1.15	100	R22	WR430	FDP/FDM	Al/Cu
HD-22WHPL250...	1.72-2.61	1.15	250	R22	WR430	FDP/FDM	Al/Cu
HD-26WHPL300...	2.17-3.30	1.15	300	R26	WR340	FDP/FDM	Al/Cu
HD-26WHPL800...	2.17-3.30	1.15	800	R26	WR340	FDP/FDM	Al/Cu
HD-32WHPL250...	2.60-3.95	1.10	250	R32	WR284	FDP/FDM	Al/Cu
HD-32WHPL500...	2.60-3.95	1.10	500	R32	WR284	FDP/FDM	Al/Cu
HD-40WHPL300...	3.22-4.90	1.10	500	R40	WR229	FDP/FDM	Al/Cu
HD-48WHPL70...	3.94-5.99	1.10	70	R48	WR187	FDP/FDM	Al/Cu
HD-48WHPL100...	3.94-5.99	1.10	100	R48	WR187	FDP/FDM	Al/Cu
HD-48WHPL400...	3.94-5.99	1.10	400	R48	WR187	FDP/FDM	Al/Cu
HD-48WHPL500...	3.94-5.99	1.10	500	R48	WR187	FDP/FDM	Al/Cu
HD-48WHPL1000...	3.94-5.99	1.10	1000	R48	WR187	FDP/FDM	Al/Cu
HD-58WHPL50...	4.64-7.05	1.10	50	R58	WR159	FDP/FDM	Al/Cu
HD-58WHPL800...	4.64-7.05	1.10	800	R58	WR159	FDP/FDM	Al/Cu
HD-70WHPL75...	5.38-8.17	1.10	75	R70	WR137	FDP/FDM	Al/Cu
HD-70WHPL150...	5.38-8.17	1.10	150	R70	WR137	FDP/FDM	Al/Cu
HD-70WHPL200...	5.38-8.17	1.10	200	R70	WR137	FDP/FDM	Al/Cu
HD-70WHPL250...	5.38-8.17	1.10	250	R70	WR137	FDP/FDM	Al/Cu
HD-70WHPL300...	5.38-8.17	1.10	300	R70	WR137	FDP/FDM	Al/Cu
HD-70WHPL500...	5.38-8.17	1.10	500	R70	WR137	FDP/FDM	Al/Cu
HD-70WHPL550...	5.38-8.17	1.10	550	R70	WR137	FDP/FDM	Al/Cu
HD-84WHPL300...	6.57-9.99	1.10	300	R84	WR112	FDP/FDM	Al/Cu
HD-84WHPL500...	6.57-9.99	1.10	500	R84	WR112	FDP/FDM	Al/Cu
HD-100WHPL100...	8.20-12.40	1.10	100	R100	WR90	FDP/FDM	Al/Cu
HD-100WHPL200...	8.20-12.40	1.10	200	R100	WR90	FDP/FDM	Al/Cu
HD-100WHPL300...	8.20-12.40	1.10	300	R100	WR90	FDP/FDM	Al/Cu
HD-120WHPL50...	9.84-15.0	1.10	50	R120	WR75	FDP/FDM	Al/Cu
HD-120WHPL75...	9.84-15.0	1.10	75	R120	WR75	FDP/FDM	Al/Cu
HD-120WHPL150...	9.84-15.0	1.10	150	R120	WR75	FDP/FDM	Al/Cu
HD-120WHPL200...	9.84-15.0	1.10	200	R120	WR75	FDP/FDM	Al/Cu



HD-120WHPL400...	9.84-15.0	1.10	400	R120	WR75	FBP/FBM/FBE	Al/Cu
HD-140WHPL50...	11.9-18.0	1.10	50	R140	WR62	FBP/FBM/FBE	Al/Cu
HD-140WHPL100...	11.9-18.0	1.10	100	R140	WR62	FBP/FBM/FBE	Al/Cu
HD-140WHPL200...	11.9-18.0	1.10	200	R140	WR62	FBP/FBM/FBE	Al/Cu
HD-140WHPL300...	11.9-18.0	1.10	300	R140	WR62	FBP/FBM/FBE	Al/Cu
HD-140WHPL400...	11.9-18.0	1.10	400	R140	WR62	FBP/FBM/FBE	Al/Cu
HD-140WHPL500...	11.9-18.0	1.10	500	R140	WR62	FBP/FBM/FBE	Al/Cu
HD-180WHPL50...	14.5-22.0	1.15	50	R180	WR51	FBP/FBM/FBE	Al/Cu
HD-180WHPL500...	14.5-22.0	1.15	500	R180	WR51	FBP/FBM/FBE	Al/Cu
HD-220WHPL100...	17.6-26.7	1.15	100	R220	WR42	FBP/FBM/FBE	Al/Cu
HD-220WHPL200...	17.6-26.7	1.15	200	R220	WR42	FBP/FBM/FBE	Al/Cu
HD-260WHPL100...	21.7-33.0	1.15	100	R260	WR34	FBP/FBM/FBE	Al/Cu
HD-320WHPL30...	26.3-40.0	1.15	30	R320	WR28	FBP/FBM/FBE	Al/Cu
HD-400WHPL10...	32.9-50.1	1.15	10	R400	WR22	FUGP	Cu
HD-400WHPL20...	32.9-50.1	1.15	20	R400	WR22	FUGP	Cu

\*Indicates Model Number. See Ordering Information for complete part number.

\*\*VSWR refers to 30% of waveguide bandwidth.

**【Ordering Information】**

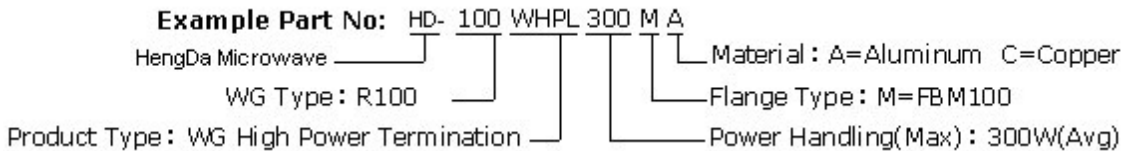

- Flange type: Multiple types available - see HengDa Microwave Flanges page
- Finish: Corrosion protection plus black top coat